

CSIR-INDIAN INSTITUTE OF PETROLEUM

DEHRADUN (U.K.) INDIA



BID DOCUMENT

Under TWO BID System
For

"Modular Furniture"

Ref No. PUR/1/416/JK/ASD/18-19/PO

Date: 28.09.2018

Last Date/Time of submission: upto 15:00 hrs (IST) on 30.10.2018

Date/Time of opening: at 15:00 hrs (IST) on 31.10.2018

To Be Submitted To

Stores & Purchase Officer
CSIR-INDIAN INSTITUTE OF PETROLEUM

P.O. IIP, MOHKAMPUR,
HARDWAR ROAD, DEHRADUN (U.K), India
Ph: 0135-2525762, 2525945
Telefax: +91-135-2660202-203

INVITATION FOR THE BIDS

Ref No. PUR/1/416/JK/ASD/18-19/PO

Date: 28.09.2018

Bids in two parts shall be submitted on CPP Portal (<https://etenders.gov.in>) , Part A(Technical Bid) : containing scanned copy of Earnest Money Deposit (EMD), Documents in support of "Eligibility Criteria", checklist & "Technical Bid" and Part B (Financial Bid): containing Financial Bid valid for 120 days are invited from eligible bidders for supply of "**Modular Furniture**" for the INDIAN INSTITUTE OF PETROLEUM (CSIR-IIP), Dehradun as per detail specification provided at the Schedule of Requirement.

1.0 Eligibility Criteria/ Pre-qualification Requirement

- I. The Bidder should be a manufacturer or a dealer specifically authorised by the manufacturer to quote on their behalf for this tender as per manufacturer authorisation form and Indian agents of foreign principals, if any who must have designed, manufactured, tested and supplied the equipment(s) similar to the type specified in the "Technical Specification".
 - II. Details of service support facilities that would be provided after the warranty period should be submitted in the Service Support Details Form.
 - III. In the case of a Bidder not doing business in India, the Bidder is/or will be (if successful) represented by an Agent in India who shall be equipped and able to carry out the Supplier's maintenance, repairs and spare parts, stocking obligations prescribed by the conditions of the contract.
 - IV. The Bidder will assume total responsibility for the fault-free operation of equipment, application software, if any.
 - V. Bidders who meet the criteria given above are subject to be disqualified, if they have made untrue or false representation in the forms, statements and attachments submitted in proof of the qualification requirements or have a record of poor performance, not properly completing the contract, inordinate delays in completion or financial failure, etc.
 - VII Bidder should submit valid documentary proof of GSTN and the details of income tax registration (PAN).
 - VIII Bidder should have to submit earnest money deposit (EMD) of Rs 25,000.00 (Rupees Twenty Five Thousands only) in the form of Bank Guarantee or Demand Draft drawn in favour of 'The Director, I.I.P., Dehradun,' on a scheduled/ nationalized bank payable at Dehradun on or before the Tender submission date and time. Delay in submission of EMD may lead the bid as non-responsive. Only online quotations will be entertained from the registered bidders of CPP Portal (www.etenders.gov.in) and the original EMD should be physically furnished in our institute on or before tender submission date.
- 1.1 CSIR-IIP reserves the right to verify/seek confirmation of all original documentary evidence submitted by vendors in support of above mentioned clauses of eligibility criteria. In case any

information furnished by the bidder is found to be false /incorrect at any stage, the bid shall be summarily rejected and no correspondence on the same shall be entertained.

- 1.2 The vendor must fulfil the above eligibility criteria/ pre-qualification conditions. Technical bid of vendors fulfilling the pre-qualification conditions will only be evaluated by the duly constituted technical evaluation committee. Bid of vendors not fulfilling the Eligibility– Criteria given above will be summarily rejected. Undertaking for subsequent submission of any of the above documents will not be entertained under any circumstances.
- 1.3 **Part –A of the bid comprising documents in support of “Eligibility Criteria”, “Technical Bid”, “Earnest Money Deposit” and check list and Part – B “Financial Bid” should be submitted on Central Public Procurement Portal (<https://etenders.gov.in>) in accordance with the instructions/terms & conditions of the tender. .**
- 1.4 An Envelope containing EMD in original addressed to the Director, I.I.P., Dehradun should reach by hand/post at the following address **on or before the Tender submission date and time:**

**The Director,
(K/A: Stores & Purchase Officer),
CSIR-INDIAN INSTITUTE OF PETROLEUM
P.O. IIP, MOHKAMPUR, HARDWAR ROAD
DEHRADUN- 248005, U.K., India**

- 1.5 The “Part A (Technical Bid)” of bid will be opened in the Purchase Section of the CSIR-IIP on the next day (last date of submission of the Bid) at 15:00 hours (IST) in the presence of bidders who choose to be present.
- 1.6 CSIR-IIP will make its purchasing decision based on the ability of the bidder to meet its Labs/Institutes long term needs, technical expertise of the bidder, delivery capability, customer references and price. However, specific criterion used to evaluate bid response is listed in the chapter “Instruction to bidders”.
- 1.7 The Director, CSIR-Indian Institute of Petroleum, P.O. IIP, Mohkampur, Hardwar Road, Dehradun- 248005 (U.K) India, CSIR-IIP reserves the right to waive any minor irregularities; accept the whole, accept part of or reject any or all bids.



(Stores & Purchase Officer)

Schedule of Requirements & Technical Specifications

1.1 Scope of the Work:

Supply, Installation, Testing, Commissioning, Support Services and on-Site Comprehensive Warranty Maintenance of the equipment as per detail technical specification given below.

Note: The bidder should undertake to provide support for the supplied systems/sub-systems for **warranty period of one year from the date of installation**. The bidders shall be required to confirm their willingness to accept the contract and indicate the terms and conditions in their technical bid along with the corresponding charges in the financial bid.

1.2 Potential suppliers should provide detailed activities time schedule, which represents the shortest practical time to complete all necessary tasks and meet the obligations of the requirements. All significant activities must be included, including those associated with the delivery, acceptance testing, installation and commissioning of the equipments/ products and quality certifications.

1.3 Technical Specifications:

The detailed technical specifications of the equipments/ systems are specified below:

SI. No	Description	Quantity
1.	Modular Furniture (The detailed description of the instrument is given in attached document)	As per attached

Please note that complete set of "Standard Bid Document" is available in our website www.iip.res.in at free of cost. The same may be downloaded and used while preparing your bid. A copy of the same may be attached along with the bid, duly signed and stamped. EMD should be in favour of Director, I.I.P., Dehradun in form of Demand Draft or Bank Guarantee. The scanned copy of EMD should be attached with your Technical Bid.

Technical specification of modular furniture for Central HPLC LAB

1. Wall Bench Size: L 3225 mm x W 900 mm x H 900 mm -1 No.
 2. Wall Cabinet for glass door L 850 mm x W 400 mm x H 600 mm -10Nos
 3. Visitor chair -8 Nos
 4. Wall Bench Size: L 3657 mm x W 750 mm x H 750 mm -1No.
 5. Island Bench Size: L 7425 x W 1500 x H 900 mm -1No.
 6. Wall Bench Size: L 775 mm x W 750 mm x H 900 mm -1No.
 7. Wall Bench Size: L 1875 mm x W 900 mm x H 900 mm -3Nos
 8. Wall Bench Size: L 900 mm x W 750 mm x H 750 mm -1No.
 9. Anti Vibration Table (AVT) Size: L 900 x W 750 x H 900 mm -1Nos
 10. Godrej Height Adjustable Revolving Stool with High Base & Back -15 Nos
 11. High Back Chair (Heavy density Form Cushion seat/back) -4 Nos
-
- 

- LEGEND:
- WB Wall Bench
- LB Lab Bench
- CP Clean Panel
- ES Electrical Socket
- ER Electrical Raceway
- TS Telephone Socket
- LS Leg Space With Foot Rest
- 750mm Module With Two Shelves
- 500mm Module With One Shelf
- 350mm Module With One Drawer & One Shelf
- 350mm Module With One Drawer & One Shelf
- 750mm Module With One Drawer & Two Shelves
- Leg Space, Keyboard Tray and CPU Trolley with Cable Manager
- Single Sided Double Tier Reagent Rack with Electrical Raceway
- Double Sided Double Tier Reagent Rack with Electrical Raceway

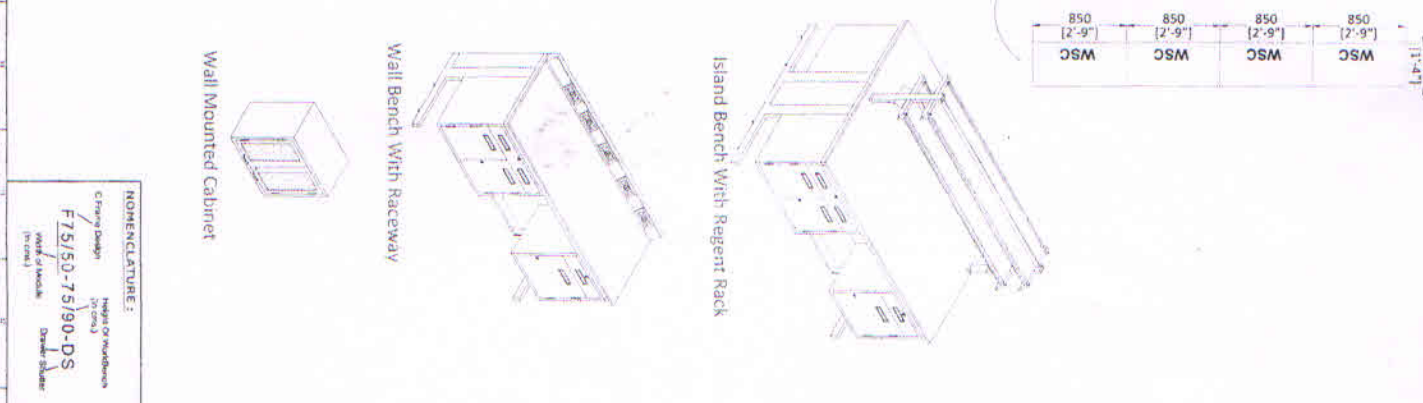
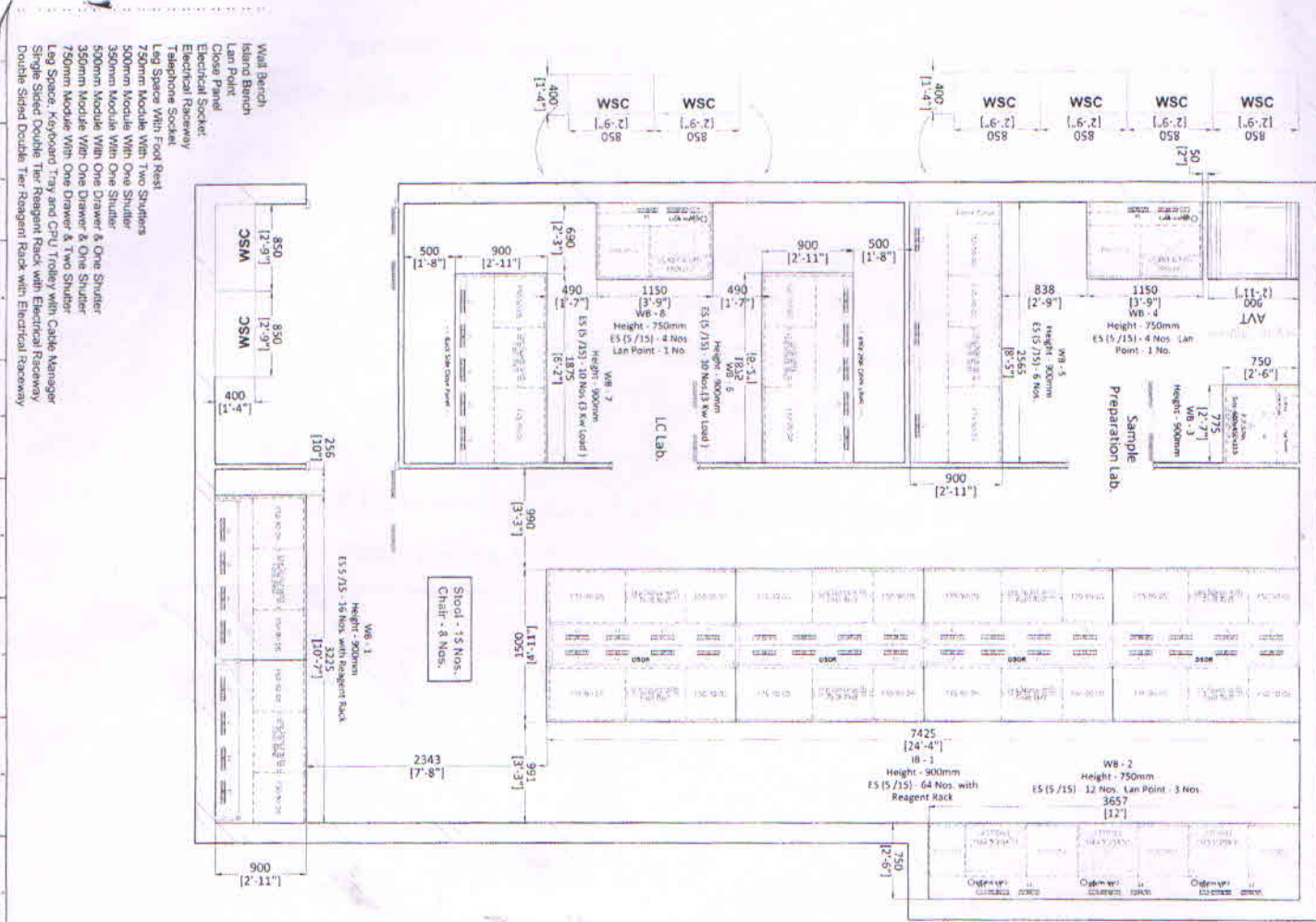

NOMENCLATURE:

C Framing Double
F75/50-75/90-DS
 Wall of Module
 Drawer Shelves

DESCRIPTION:

DRN: C/25
 CHK: APP
 DATE: 16/09/2017

CLIENT: IIP - Dehradun

SCALE: N.T.S.

SHEET NO.: 1 OF 01

REV. NO.: R0

MARK	DESCRIPTION	DATE
XX	XXX	

Citizen Industries
 Citizen Arena, Opp. Noida Hospital, Jhavarangaur, Ameerabad

DESCRIPTION: PROPOSED LAYOUT OF LABORATORY WORKSTATIONS (C - Framing Design)

SYMBOL	DESCRIPTION
	Electrical Points 6/15 Amp (1+1)(Legend Make)
	Telephone Point
	Data Socket
	Work top Mounted One Way Valve
	Work top Mounted Two Way Valve
	Electrical Raceway
	P.P. Sink with Three-way Water Tap
	S.S. Sink with Three-way Water Tap
	Service Pendant
	Peg Board (Phenolic Resin construction)
	Double Outlet Eye Wash
	Leg Space with foot rest
	Knee Space with Key Board Tray & CPU Trolley
	Single Sided Double Tier Reagent Rack
	Double Sided Double Tier Reagent Rack
	Spot Extractor
	Emergency Safety Shower with Eye Wash

• All Dimensions are in "mm"
 • C Frame System
 • Handle in Flush Type
 • Single place molded PP sink
 (SIZE: L:Size-600mmxW:450mmxD:315mm)
 Worktop in 18 +1 mm thick Black Granite Construction.

[Signature]